



# aquauno VIDEO PLUS

DIGITAL  
WATER TIMER

## INSTRUCTIONS MANUAL

VIDEO 2 PLUS 8412

VIDEO 6 PLUS 8413



# claber®

1

UK  
17

F  
33

D  
49

E  
65

P  
81

S  
97

NL  
113

GR  
129

# AQUAUNO VIDEO PLUS

## DIGITAL WATER TIMER

THANK YOU FOR CHOOSING OUR TIMER. CAREFULLY READ THE INSTRUCTIONS MANUAL BEFORE PROGRAMMING. EACH SECTION CONTAINS ALL THE INFORMATION REQUIRED FOR THE CORRECT EXECUTION OF EACH OPERATION.

### LEGENDA:

- ① 3/4" THREAD FEMALE CONNECTOR
- ② LIQUID CRYSTAL DISPLAY
- ③ BACKWARD PUSH-BUTTON
- ④ FORWARD PUSH-BUTTON
- ⑤ ENTER KEY
- ⑥ QUICK-CLICK SYSTEM FITTING
- ⑦ TIMER UNIT COVER

## CE DECLARATION OF CONFORMITY

WE DECLARE UNDER OUR SOLE RESPONSIBILITY THAT THIS PRODUCT IS IN CONFORMITY WITH THE FOLLOWING STANDARDS OR STANDARDIZATION DOCUMENT: EN 55022/CEI ENV 501 40 TO THE PROVISIONS OF THE REGULATIONS 89/336/ EEC.

CE 97

DANIELE PAPAIS





## CONNECTION TO THE TAP

UNSCREW EXTERNAL RING NUT **C** AND TIGHTEN 3/4" FEMALE CONNECTOR **A** ON THE 3/4" TAB **B**.  
FIX THE TIMER TO THE TAP BY TIGHTENING RING NUT **C**.

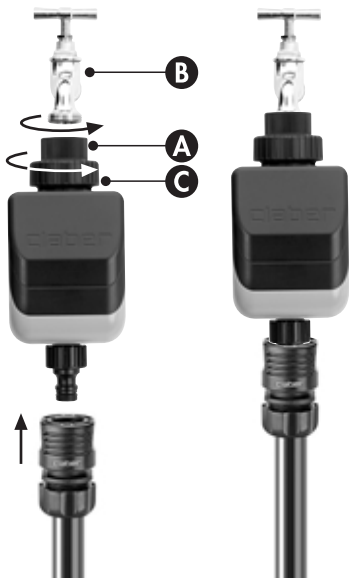

---

# WATER PRESSURE TABLE

<b>BAR</b>	<b>0,5</b>	<b>1</b>	<b>2</b>	<b>2,5</b>	<b>3</b>	<b>4</b>	<b>5</b>
<b>l/min</b>	<b>11</b>	<b>16</b>	<b>22</b>	<b>25</b>	<b>27</b>	<b>31</b>	<b>35</b>

## VOLTAGE -POWER TABLE

### 1x 9 VOLT ALKALINE BATTERY.

**DURATION:** THIS BATTERY IS SUFFICIENT TO POWER THE TIMER FOR AN ENTIRE SEASON WITH AN AVERAGE OF 2 DAILY WATERING CYCLES.

TO PREVENT THE RISK OF CORROSION CAUSED BY ACID, REMOVE THE BATTERY FROM THE TIMER DURING PERIODS OF THE INACTIVITY. WHEN THE CHARGE IS TOO LOW, THE TIMER AUTOMATICALLY INTERRUPTS OPERATION BY CLOSING THE SOLENOID VALVE.

---

## BATTERY CHARGE CONTROL

THE TIMER AUTOMATICALLY REGULATES THE BATTERY CHARGE STATUS. THE UNIT COMES COMPLETE WITH POLARITY INVERSION PROTECTION AND THE BATTERY STATUS INDICATOR. THE BATTERY IS FULLY CHARGED WHEN THE MESSAGE **BATTERY** IS COMPLETE, AND RUN DOWN WHEN THE MESSAGE INDICATED IS **BATTERY**.

## KEY PAD

THREE BUTTONS ARE USED TO PROGRAM ALL THE PARAMETERS. USING THESE BUTTONS YOU CAN SELECT THE VARIOUS OPERATION MODES AND CHANGE THE CURRENT TIME SETTING, WATERING CYCLES AND DAYS.

EACH TIME YOU PRESS ONE OF THE BUTTONS A BEEP CONFIRMS THE COMMAND GIVEN.



## THE DISPLAY

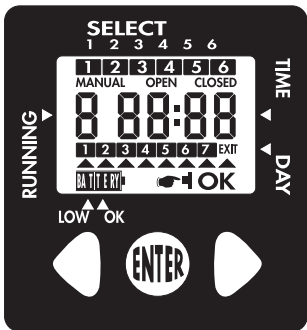

---

## FITTING THE BATTERY

USING THE TWO SIDE BUTTONS ON THE FRONT PANEL, SIMPLY DISCONNECT AND PRESS-FIT THE BATTERY TERMINALS.

MAKE SURE THAT THE BATTERY IS CORRECTLY POSITIONED IN ITS HOUSING.

REPLACE THE BATTERY WITHIN 15 MINUTES TO AVOID LOSING THE SET PROGRAMS

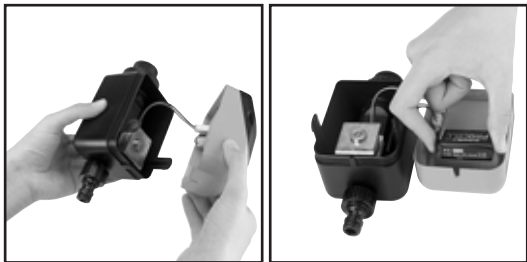

## SETTING THE CURRENT TIME

AS SOON AS THE BATTERY HAS BEEN CONNECTED ALL THE DISPLAY SECTIONS SWITCH ON.  
THE VALVE OPENS FOR 2 SECONDS AND THE TIMER SETS TO 00:00.

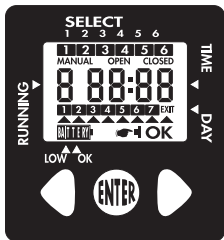

BY PRESSING THE CENTRAL **ENTER** BUTTON THE MESSAGE OK IS DISPLAYED. PRESS ◀ OR ▶ TO INCREASE OR DECREASE THE TIME SETTING ACCORDINGLY.  
FOR RAPID MOVING, SIMPLY HOLD THE RELATIVE BUTTON PRESSED DOWN UNTIL YOU REACH THE TIME SETTING REQUIRED. TO EXIT FROM THIS PAGE, PRESS **ENTER**.

## PROGRAMMING

THE PROGRAM COMPRISES A NUMBER OF PAGES, EACH OF WHICH CONTAINS TWO FUNCTIONS:

1. PROGRAM DISPLAY
  2. PROGRAM MODIFICATION
- PRESS ▶ TO MOVE FORWARDS THROUGH THE PROGRAMS.



PROGRAM 1 - START PROGRAM 1 (OPEN) - STOP (CLOSED)  
PROGRAM 2 - START PROGRAM 2 (OPEN) - STOP (CLOSED) ETC.

**ATTENTION:** IF, WHEN OPENING THE FIRST PROGRAM (OPEN) YOU HAVE WRONGLY PUSHED **ENTER** TWICE, THE NUMBER OF THE PROGRAM (1) WILL BE DISPLAYED WITH RUN TIME FROM 00:00 TO 00:01. TO RE-SET THE FIRST PROGRAM YOU HAVE TO CANCEL THE ONE WRONGLY SET (PAGE 14)

**FOR EXAMPLE:**





26

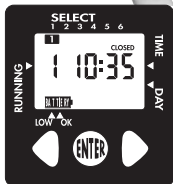

WATERING PROGRAM 1 IS SET TO START (OPEN) AT 10:26 AND END (CLOSED) AT 10:35



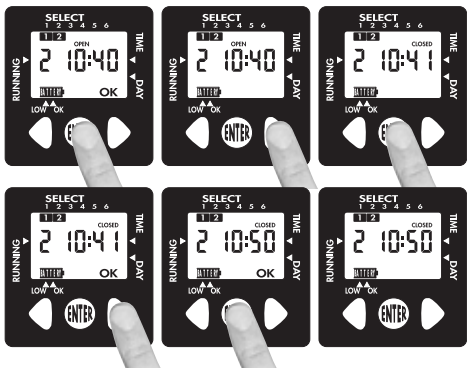

WATERING PROGRAM 2 IS SET TO START AT 10:40 AND  
 END (CLOSED) AT 10:50  
 BY MOVING WITH ► YOU CAN SET THE OTHER  
 PROGRAMS IN THE SAME WAY.  
 PRESS ◀ TO RETURN TO TIME-SETTING MODE.  
 MOVE WITH ► TO ACCESS WEEKLY WATERING MODE.

# WEEKLY PROGRAMMING

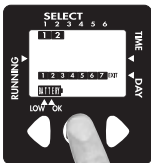

**WARNING:** DAY (1) IS THE FIRST DAY THE FIRST PROGRAM IS SET. EXAMPLE: THE FIRST PROGRAM WAS SET ON THURSDAY – DAY (1) = THURSDAY (AS DISPLAYED ON THE CURRENT TIME PAGE).

**WARNING:** DAY (1) IS A REFERENCE FOR THE WEEKLY PROGRAM MANAGEMENT.

EXAMPLE: IF DAY (1) = THURSDAY AND YOU DO NOT WISH TO RUN A WATERING CYCLE ON FRIDAYS, ELIMINATE DAY (2)

PRESS ◀ OR ▶ TO MOVE THE CURSOR TO THE NUMBER OF THE DAY YOU WISH TO OMIT AND PRESS **ENTER** TO DELETE SAID DAY. TO EXIT FROM THIS PAGE, POSITION THE CURSOR UNDER EXIT AND CONFIRM WITH **ENTER**.

AFTER EXITING THE WEEKLY WATERING CYCLE PAGE, PRESS ▶ TO DISPLAY MANUAL FUNCTION MODE.

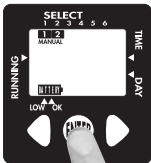

PRESS ◀ (OPEN) TO OPEN THE VALVE AND ▶ (CLOSED) TO CLOSE IT AGAIN. THE VALVE CLOSES AUTOMATICALLY AFTER 15 MINUTES IN ANY CASE.

**TO DELETE A PROGRAM** USE THE ▶ KEY TO MOVE FORWARDS UNTIL YOU REACH THE PROGRAM TO BE CANCELLED. THE DELETION PHASE (CLOSED) IS THEN ENTERED BY PRESSING . TO DELETE THE PROGRAM, SIMULTANEOUSLY PRESS BUTTON ◀ AND ▶, TAKING CARE TO PRESS THE ◀ BUTTON SLIGHTLY IN ADVANCE.

EACH TIME YOU PRESS TO ACCESS A PROGRAM AND DO NOT MODIFY ITS DATA WITHIN 10 SECONDS, THE PROGRAM EMITS AN ACOUSTIC SIGNAL AND .

## INSTRUCTIONS

- DO NOT ALLOW THE APLIANCE TO FREEZE OVER.
- DO NOT USE AQUAUNO VIDEO ON HOSES CONTAINING CHEMICAL SUBSTANCES OR ANY LIQUID OTHER THAN WATER
- DO NOT USE HEAVY OBJECTS TO PRESS THE BUTTONS WHICH HAVE BEEN SPECIALLY DESIGNED TO RESPOND TO THE TOUCH OF A FINGER
- DO NOT OPERATE AQUAUNO VIDEO WHEN INLET PRESSURE EXCEEDING 10 BAR.
- ONLY USE NEW BATTERIES AND DULY REPLACE WHEN INDICATED BY THE DISPLAY.
- WHEN NOT PROGRAMMING, KEEP THE COVER CLOSED TO PROTECT THE DISPLAY FROM EXPOSURE TO SUNLIGHT AND HUMIDITY.
- AT LEAST ONCE A SEASON, CLEAN THE SINHTHETIC FOAM FILTER UNDER RUNNING WATER. IN THE CASE OF HARD OR RAIN WATER, THE FILTER MUST BE CLEANED MORE FREQUENTLY.

## CONNECTING TO A RAIN SENSOR

THE AQUAUNO VIDEO CAN BE CONNECTED TO A RAIN SENSOR (CLABER CODE 90915). THE RAIN SENSOR CUTS OFF THE AQUAUNO VIDEO WATERING PROGRAM IN CASE OF RAIN, RESTORING IT AUTOMATICALLY WHEN THERE IS NO MORE WATER LEFT IN THE SENSOR.

THE RAIN SENSOR MUST BE CONNECTED TO THE TWO SPECIAL ELECTRICAL CONTACTS PROVIDED INSIDE THE AQUAUNO VIDEO PROGRAMMING MODULE, USING THE CONNECTOR SUPPLIED WITH THE SENSOR. THE TWO-WIRE CABLE MUST BE FED IN THROUGH THE SEAT PROVIDED IN THE BOTTOM OF THE AQUAUNO VIDEO. BEFORE FITTING THE CONNECTOR, REMOVE THE JUMPER PLACED OVER THE TWO CONTACTS. FOR THE CONNECTION DIAGRAM, SEE RIGHT.

