

COLIBRÌ SYSTEM

With the new Colibri System, all the advantages of the underground irrigation system are finally accessible for small gardens too. A simple, convenient idea, designed with DIY in mind, it comes complete with everything the gardener needs: from the new Colibri pop-up micro-sprinklers, 1/2" polyethylene tube, the push-on couplings for all types of lay-outs, through to the drainage valve (to protect the system from even the coldest winters) and battery-powered timers, to ensure that lawns and gardens are watered at the best time of the day, even when the owner is away or on vacation. All this, with one extra advantage: total Claber quality, certified ISO 9001.

Daily water requirement (in litres)

| | 1st system | full development |
|--------|----------------------|------------------|
| lawn | 4 l per sq m | |
| hedge | 4 l/running m | 8 l/running m |
| shrubs | 8-16 l/running m | as per lawn |
| garden | 3 l per square metre | |

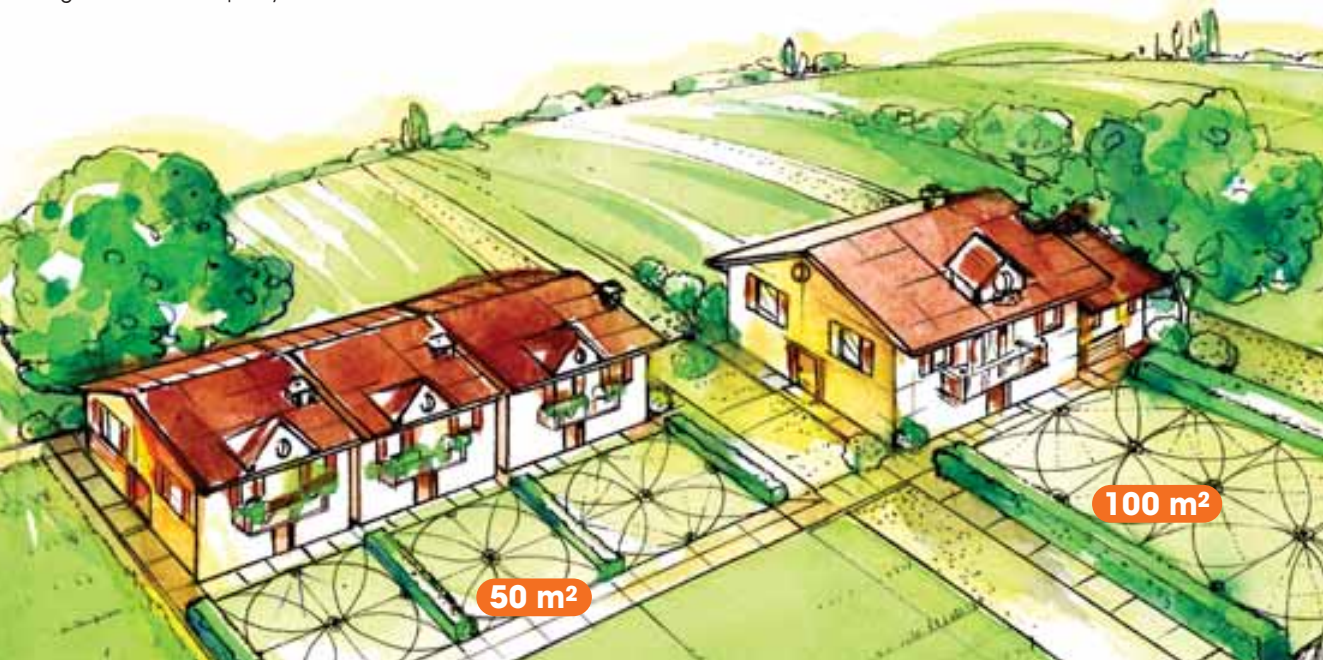

The Colibri System has been designed especially for gardens between **50 m² and 200 m²**. As the examples show, all areas can be covered perfectly by selecting and combining different micro-sprinkler types: 90°, 180° and 360°. Irrigating with the right amount of water is good for the garden, and for the gardener's pocket. Water is without doubt a precious resource - and thanks to the versatility, watering uniformity and low pressure requirements of Colibri System micro-sprinklers, you'll be able to use it to maximum advantage, down to the last drop. And you can also program the system watering cycles for the best possible time, whatever the climatic conditions or the type of garden, with the help of the table shown on this page.

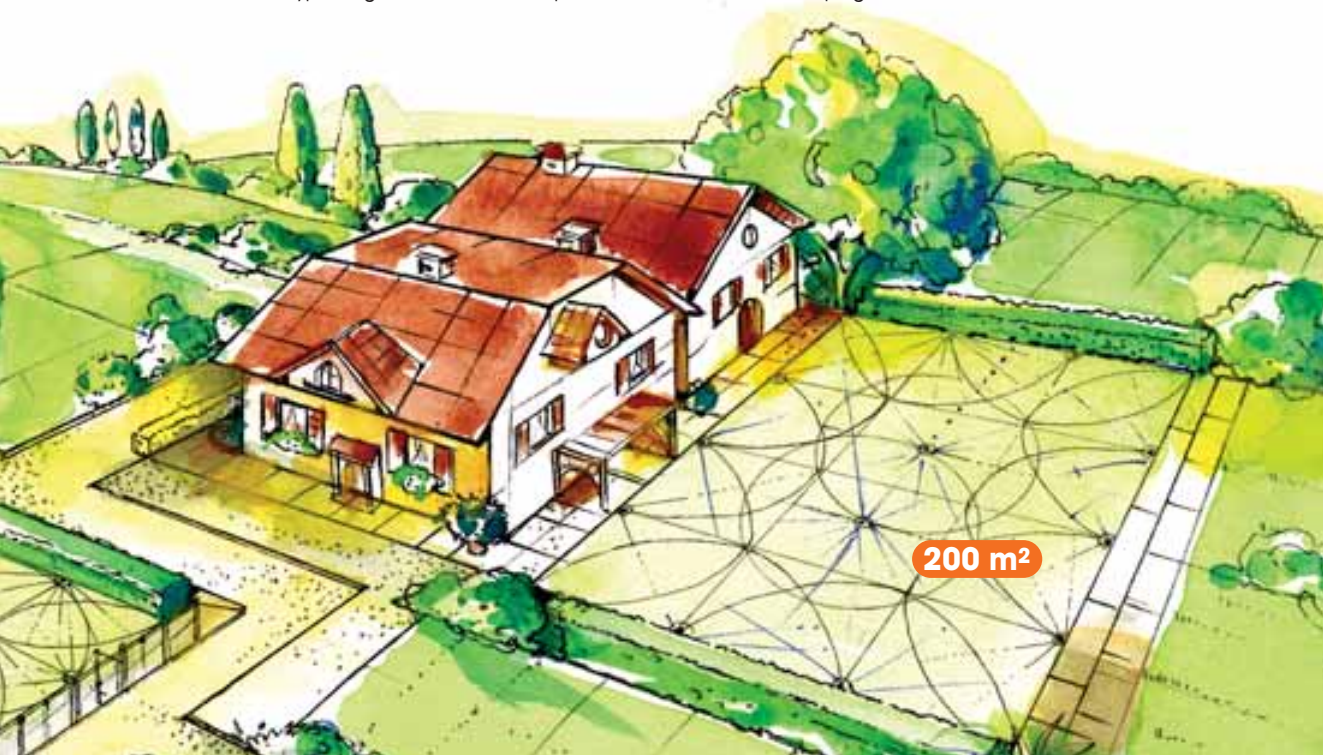

PLANNING

To plan your own system, prepare a scale plan of your garden and use a compass to mark the circles (360°) or sectors (90° and 180°) of the areas to be watered, as shown in the example alongside. For best results, position the 90° sprinklers in the corners, the 180° sprinklers along the perimeter of the garden or the house, and the 360° sprinklers in open spaces.

Now trace the path of the main tube to establish the required length. Refer to the table below for operating water pressure and performance data of each sprinkler.

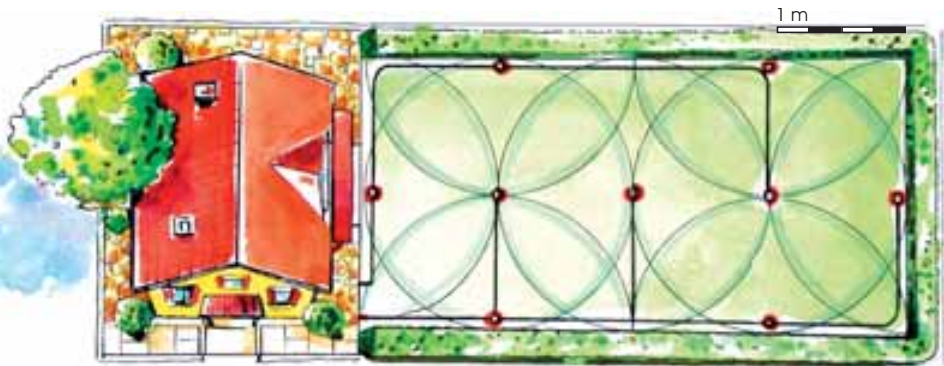

| | BAR | l/min | r. | m ² |
|------|-----|-------|-------|----------------|
| 90° | 1,5 | 1,1 | 4,2 m | 13,8 |
| | 2,0 | 1,3 | 4,5 m | 15,9 |
| | 2,5 | 1,5 | 4,7 m | 17,3 |
| 180° | 1,5 | 1,7 | 4,0 m | 25,1 |
| | 2,0 | 2,0 | 4,5 m | 31,8 |
| | 2,5 | 2,3 | 4,7 m | 34,7 |
| 360° | 1,5 | 3,3 | 3,7 m | 50 |
| | 2,0 | 3,7 | 4,2 m | 64 |
| | 2,5 | 4,2 | 4,5 m | 71 |

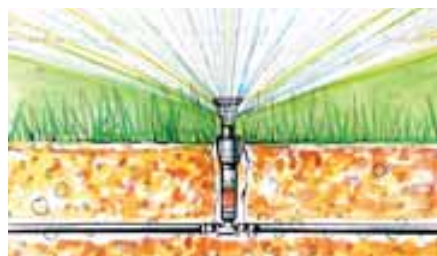

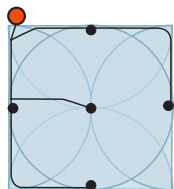

1 8411

4 90220
180°

1 90210
360°

50 m²

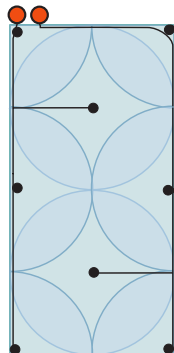

1 8410

4 90230
90°

2 90220
180°

2 90210
360°

130 m²

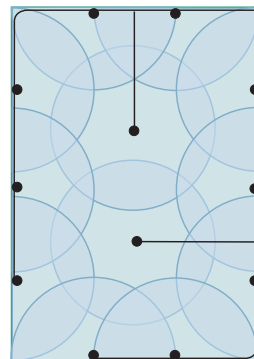

1 8410

2 90220
180°

2 90210
360°

200 m²



claber

INSTALLATION GUIDE



To install the Colibri System, proceed as follows. First of all, plant a stake at each point where a sprinkler is to be installed. Now join the stakes with string to trace the path that will be followed by the main tube. At this stage, use a spade to mark out a trench along the path, pushing the blade to full depth. There's no need to dig; simply work the blade back and forth, as illustrated, to make a space in the ground that is sufficient for the tube, without actually removing any soil or damaging the turf.





Once the path has been marked out, connect the 1/2" tube to the timer, then unroll it along the path and up to the first stake. Cut the tube to length with a pair of scissors, then fit the threaded tee (the connection can be made even more secure by using a clamp).



Screw the sprinkler onto the tee and set it temporarily on the stake, for example with a turn of insulating tape. Proceed with another length of tube and the next micro-sprinkler, and so on, until you have completed the entire circuit with the last sprinkler (or with the drainage valve or the plug).



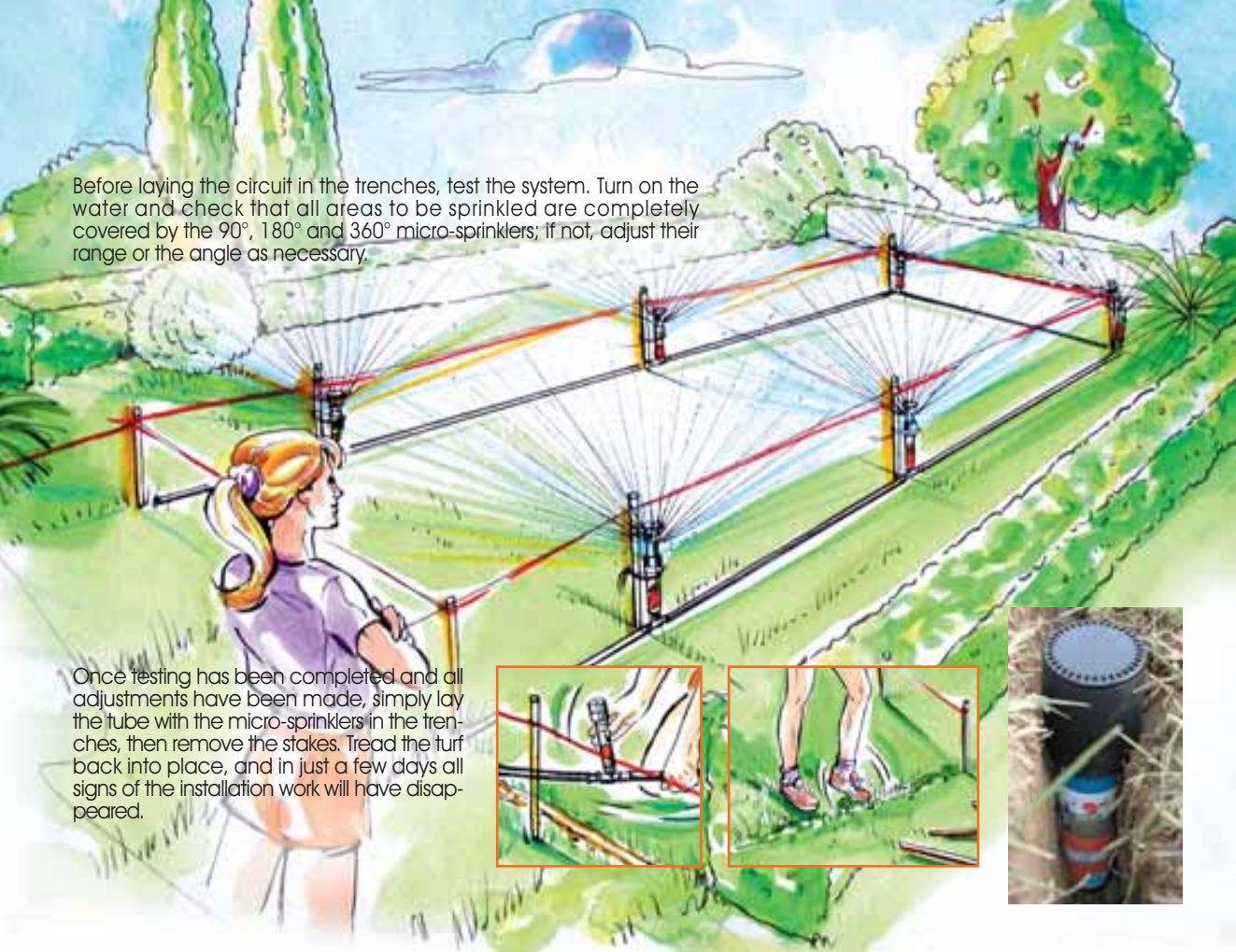

Before laying the circuit in the trenches, test the system. Turn on the water and check that all areas to be sprinkled are completely covered by the 90°, 180° and 360° micro-sprinklers; if not, adjust their range or the angle as necessary.

Once testing has been completed and all adjustments have been made, simply lay the tube with the micro-sprinklers in the trenches, then remove the stakes. Tread the turf back into place, and in just a few days all signs of the installation work will have disappeared.



Colibri System micro-sprinklers are designed for easy and precise adjustment both of the watering range (i.e. the distance covered by the water jet) and of the operating position (for 90° and 180° models).

To adjust the watering range, simply disassemble the top of the micro-sprinkler and rotate the screw with a 3 mm Allen key. To alter the jet angle, raise and rotate the micro-sprinkler shaft.

Remember to carry out these operations before laying the circuit in the trenches; bear in mind also that the micro-sprinkler is factory-set to the maximum range.



For best results when installing Colibri sprinklers, fit a collar (code 90250) as shown in the example, to protect them against sand and pebbles in the ground.

